



Envisioning the Future :

# LIMU's Physical Masterplan

2023-2035

Phase 4 : Final Design  
January-2024

# Contents:

- 1 | Reviewing The Masterplan Concept
- 2 | The Site Study
- 3 | LIMU's New Masterplan
- 4 | The Infrastructure
- 6 | Vision into Reality



# QUICK REVIEW

What is a masterplan ...Why we should have it ... What are its quality criteria

# The Masterplan Concept :

- physical Masterplanning is a crucial aspect of urban design that involves determining the appropriate capacities and sizes for various building types and identifying their optimal locations and heights. It also involves studying the open spaces, circulation systems, utilities, and other elements of the environment to create a comprehensive plan for the area.
- The physical master plan must have as its touchstone the mission and strategic plan.



# The Purpose of Masterplanning

Generally, it is to organize the development of an area or project, envision changes, and prepare for the future.

## In a deeper look, it is also for...

- Marketing
- Analyzing potential for future development
- Guiding building and landscape design
- Supporting improved funding opportunities
- Creating and enhancing partnerships
- Increasing operating efficiencies
- Improving space allocation and utilization
- Ensures harmony in future architecture design

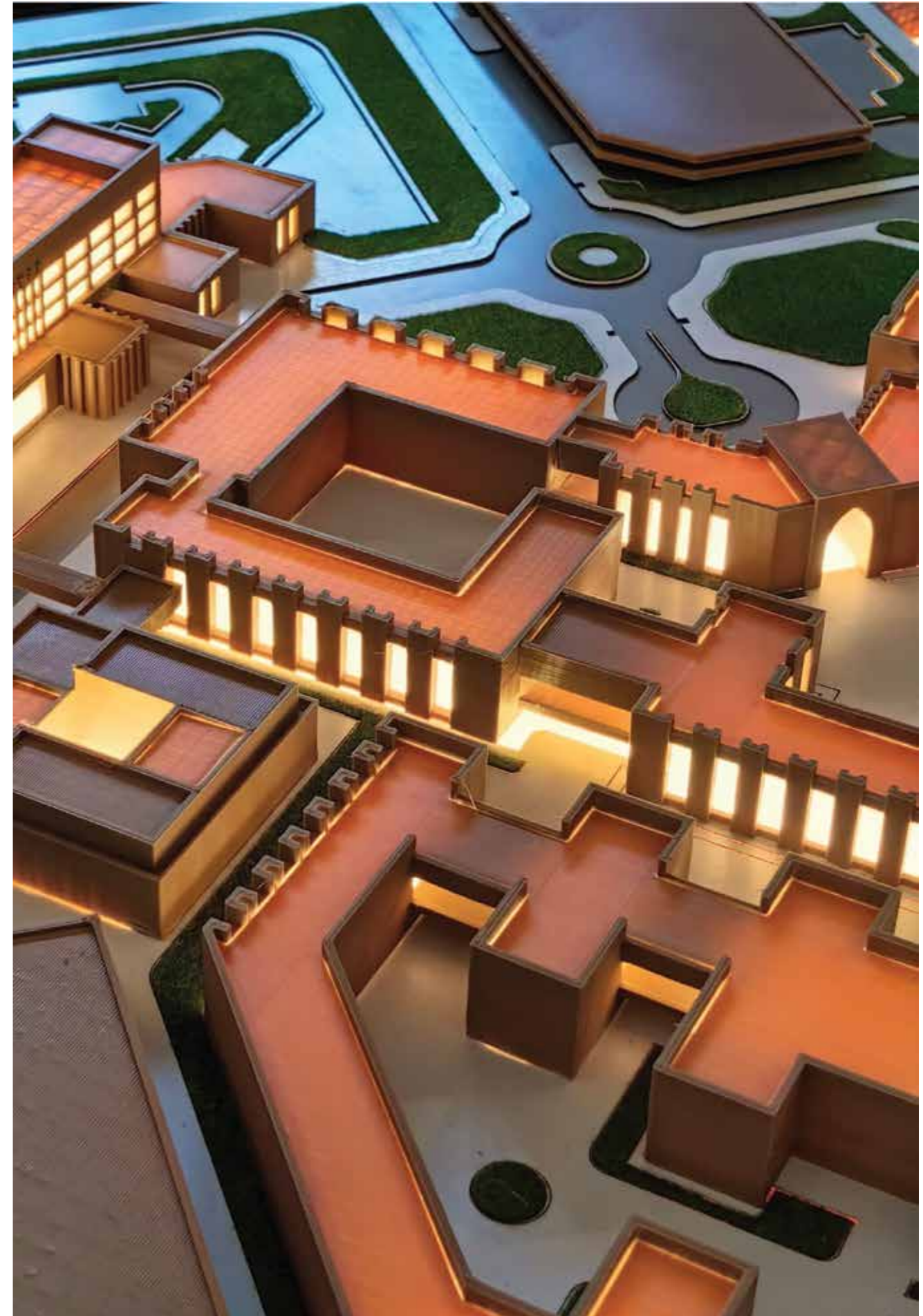

# The Quality Criteria of a Masterplan

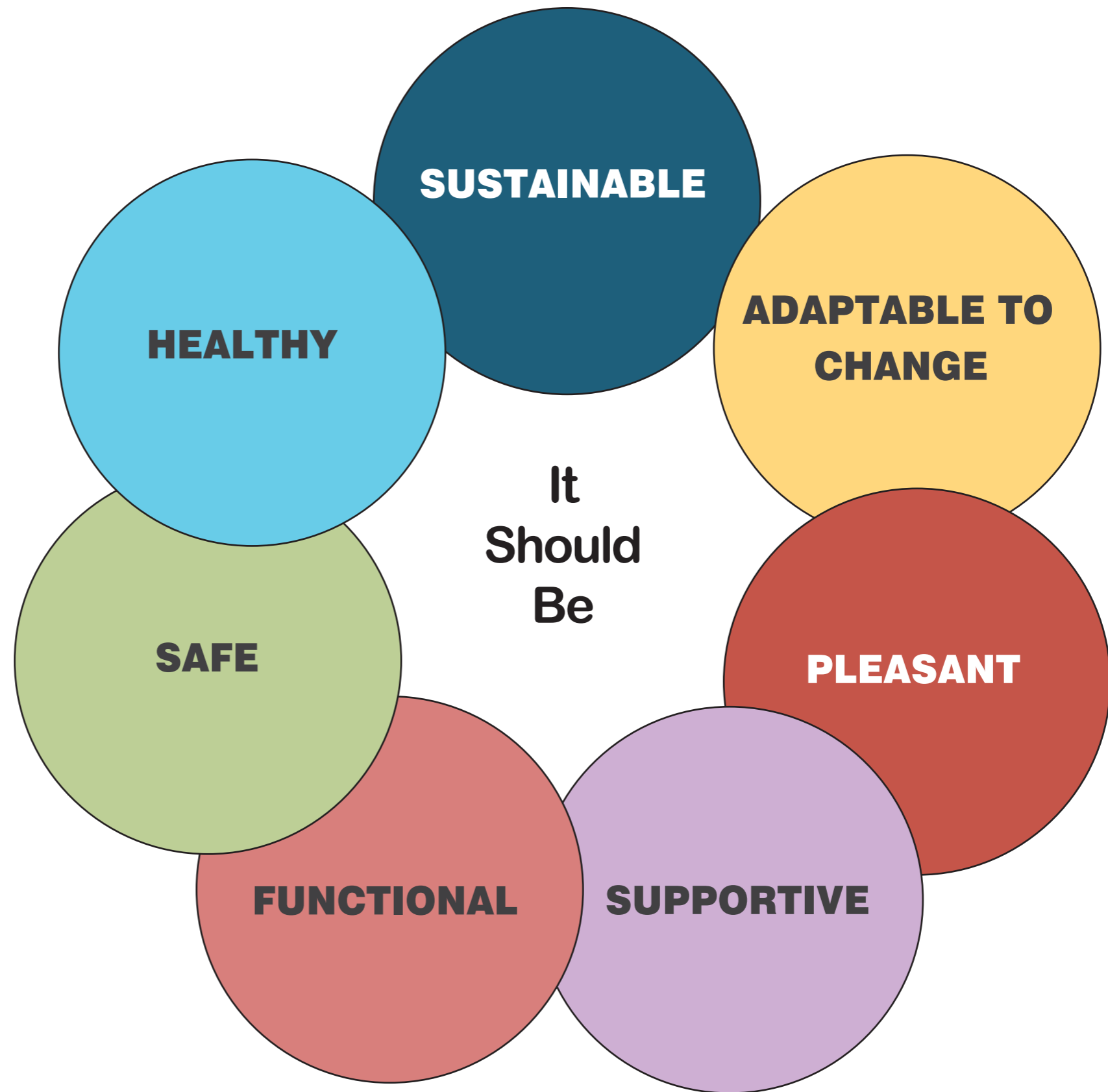

# The Design Objective

The university's physical Masterplan 2023-2035 The ultimate goal of this plan is to create a modern and sustainable campus environment that promotes excellence in education and innovation. The plan focuses on the creation of green spaces, innovative buildings, and improved accessibility for everyone. Additionally, it includes initiatives to integrate renewable energy sources, conserve water, and reduce waste.

# Site Study



# Site Location

- Bu-Fakhra, Benghazi , Libya
- Located on a regional road
- Near Benghazi sub business district “6.30 km”
- Adjacent to the Al-Marisa Free Zone and close to the smart city inside of it
- Not far from the sea shore

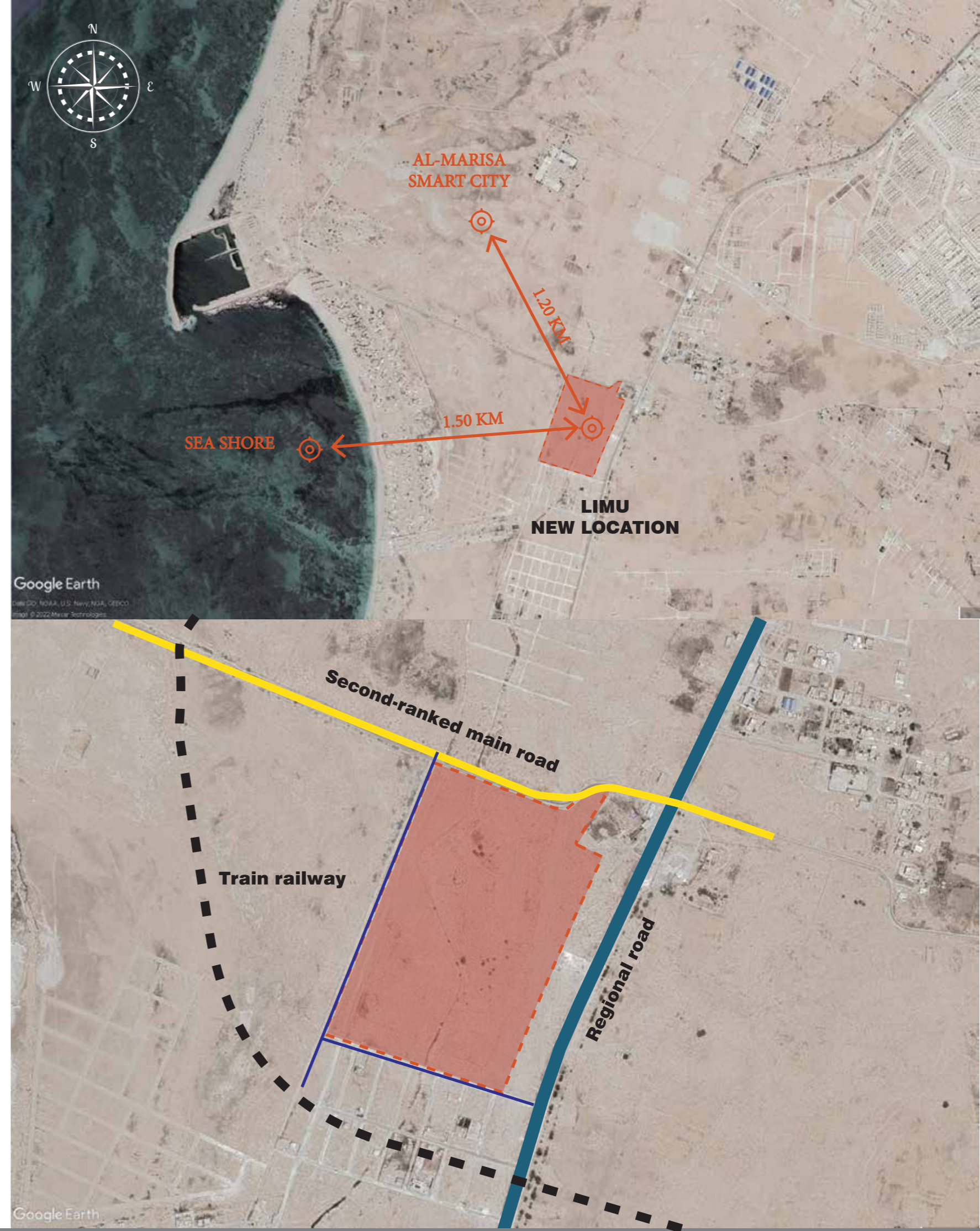

# The Landuse of the surroundings

-The landuse of the surrounding area of the site has various usages, from commercial use to tourist use, to even a naturally preserved area, all of which work in the favor of the site.

-At the moment, there are no significant projects noted next to the site, but there is a plan for the Al-Marisa Free Zone project, which will have a substantial impact on the area, and on the flow of traffic from downtown Benghazi to the site.



**LIMU  
NEW LOCATION**

# Survey work

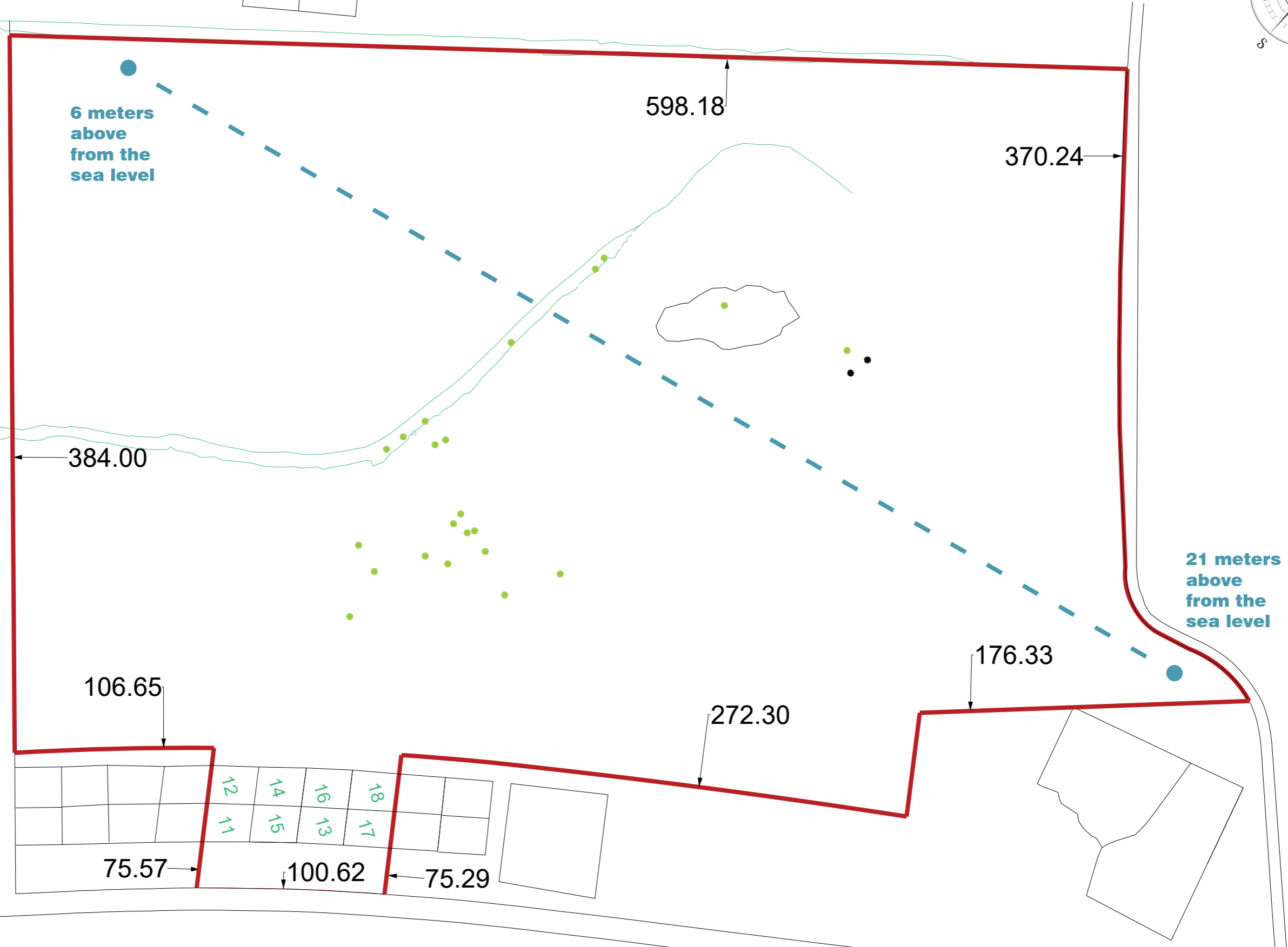
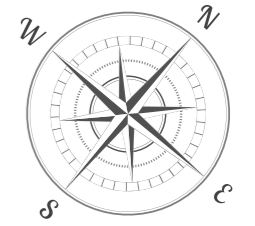

**Total area : 233500 Sqm**

# LIMU's New Campus



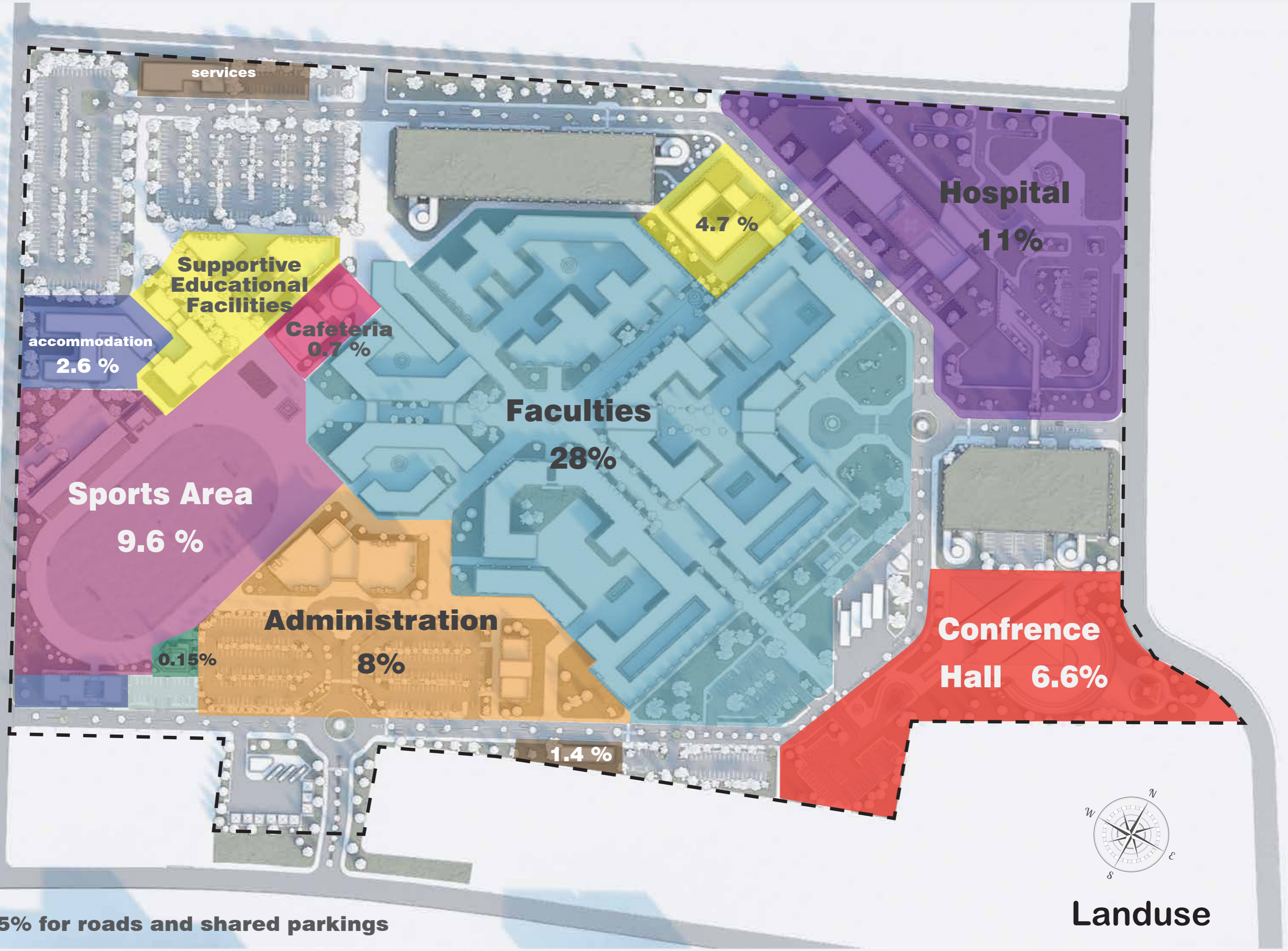

27.25% for roads and shared parkings

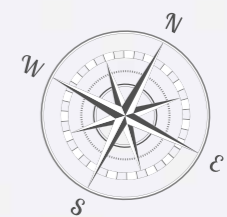

Landuse



The General Arrangement

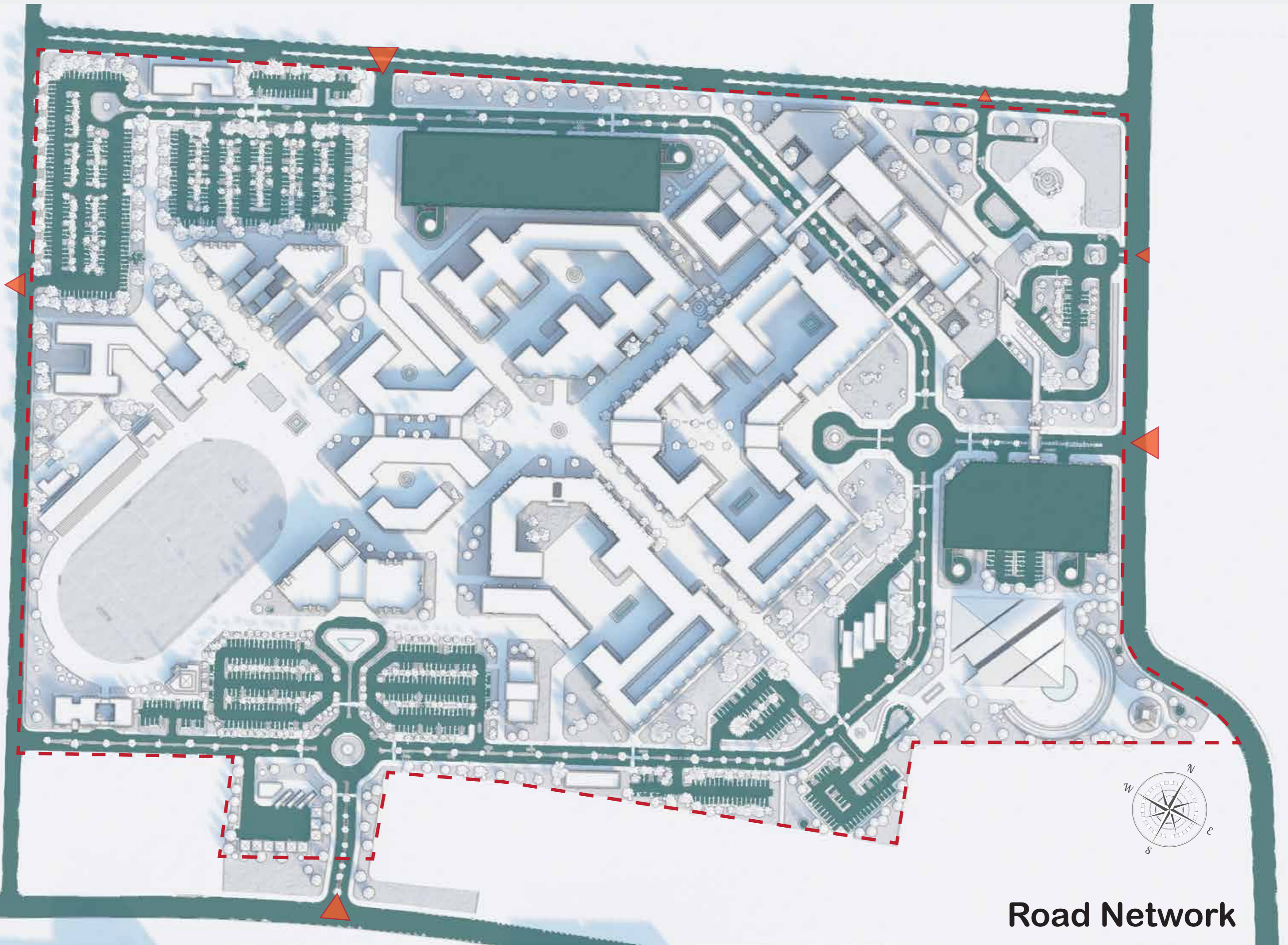

Road Network

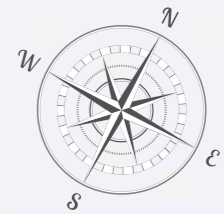
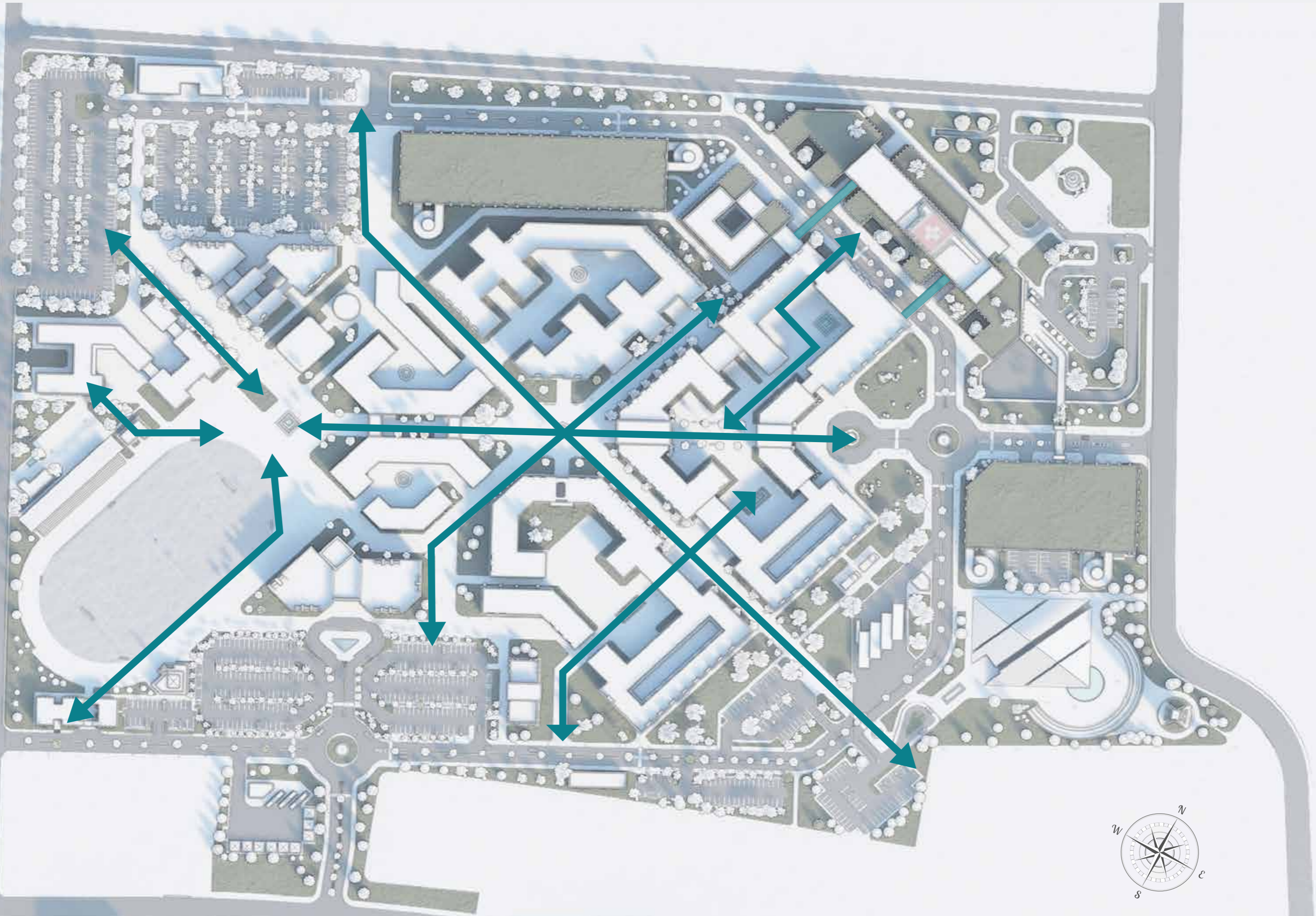

**Main Pedestrians Paths**



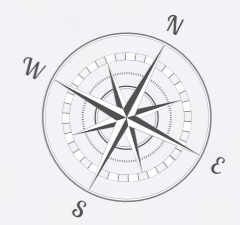
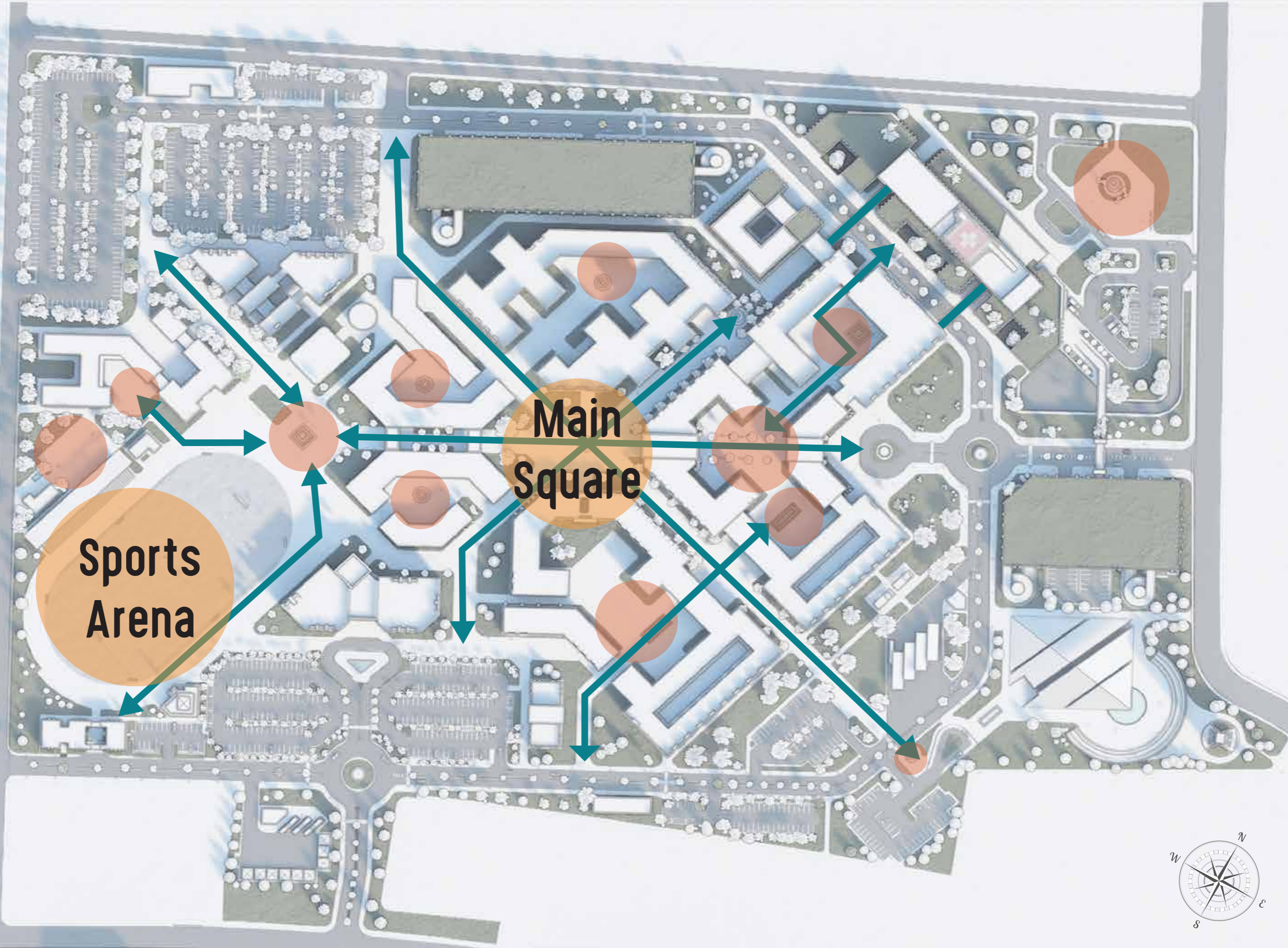

**Nodes and Squares**

# Buildings

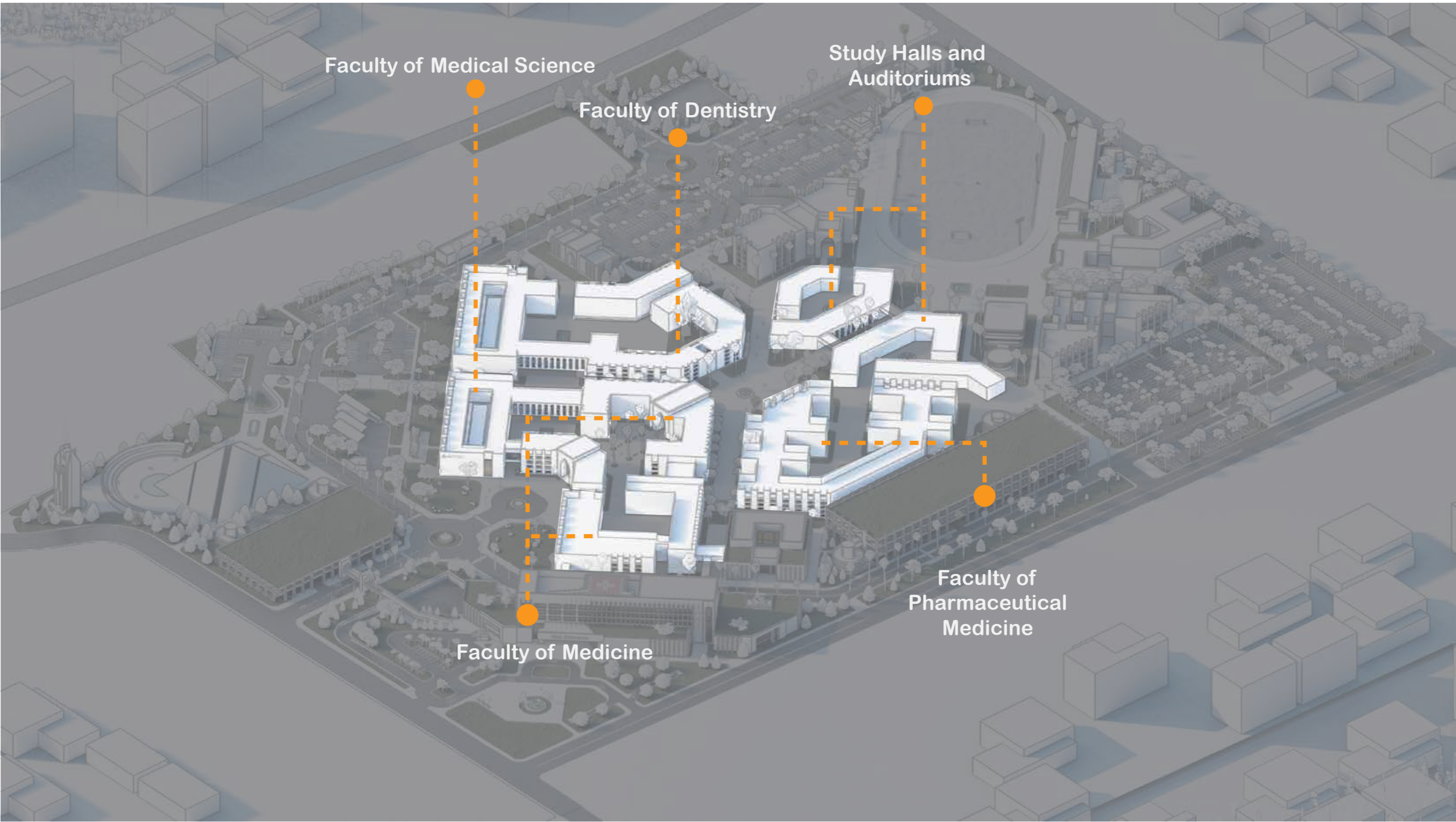

The Medical Faculties of the University

# Buildings

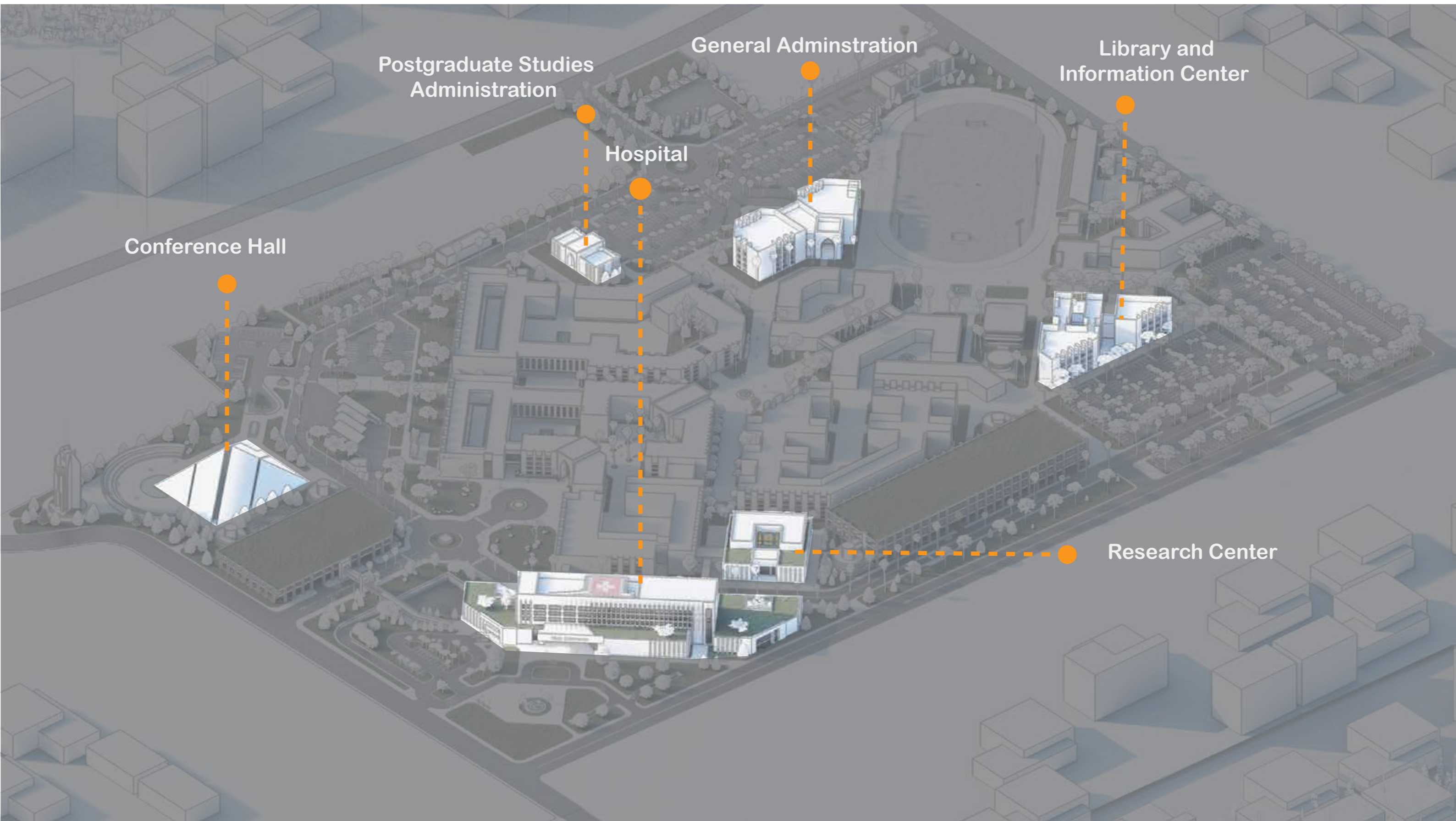

Auxiliary Educational Facilities

# Buildings

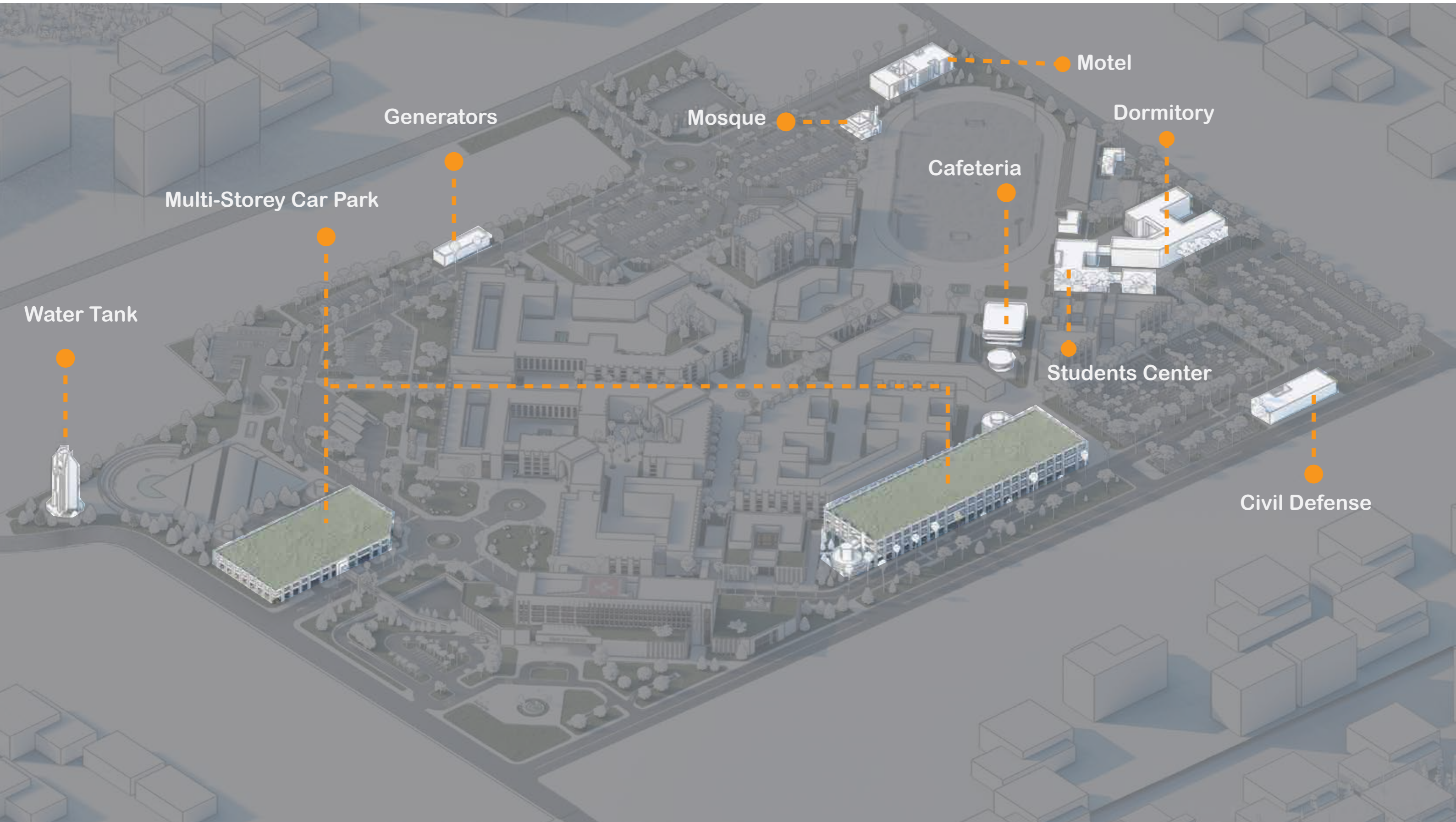

Service Buildings / Supportive Buildings



**View of the Faculties Entrance**



**View of the Conference Hall**



**View From Main Square**



**View From Main Square**





**View of the Hospital**



**View of the General Administration**



**Aerial View**

Scan to  
See the  
Video



# The Infrastructure

# The Electric Plan



# Water Supply Plan

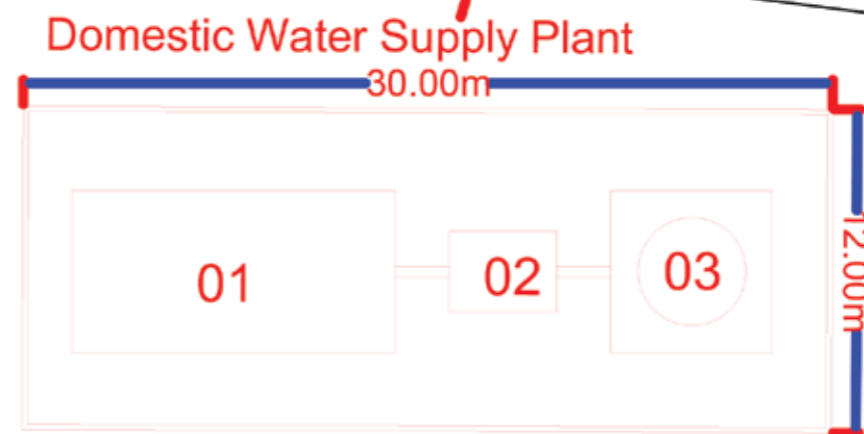
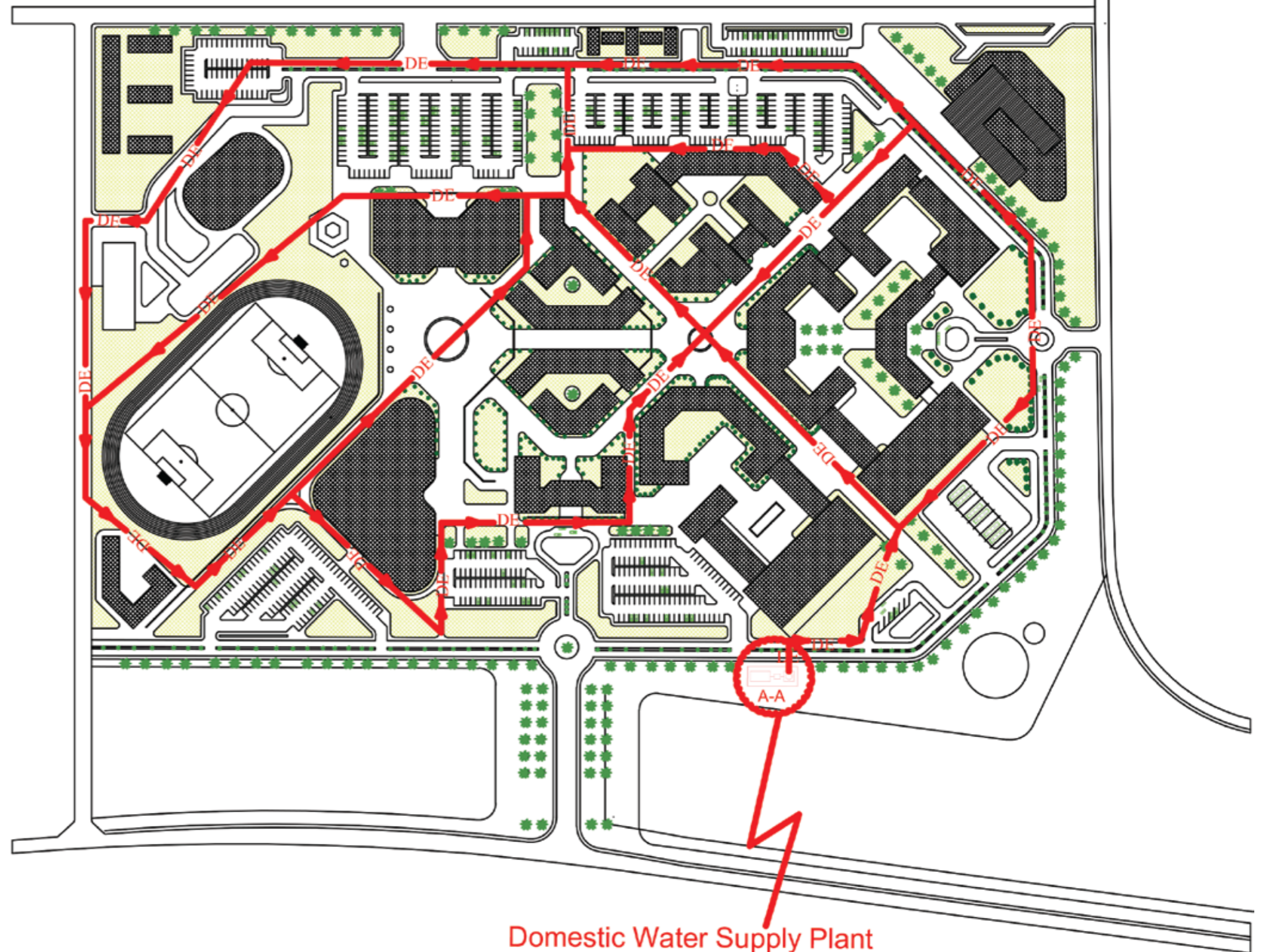

- 01- Under Ground Water tenk
- 02- Pump Room
- 03- Eleveted Water Tank

# Water Treatment Plan

Sewage Collection Treatment Plant

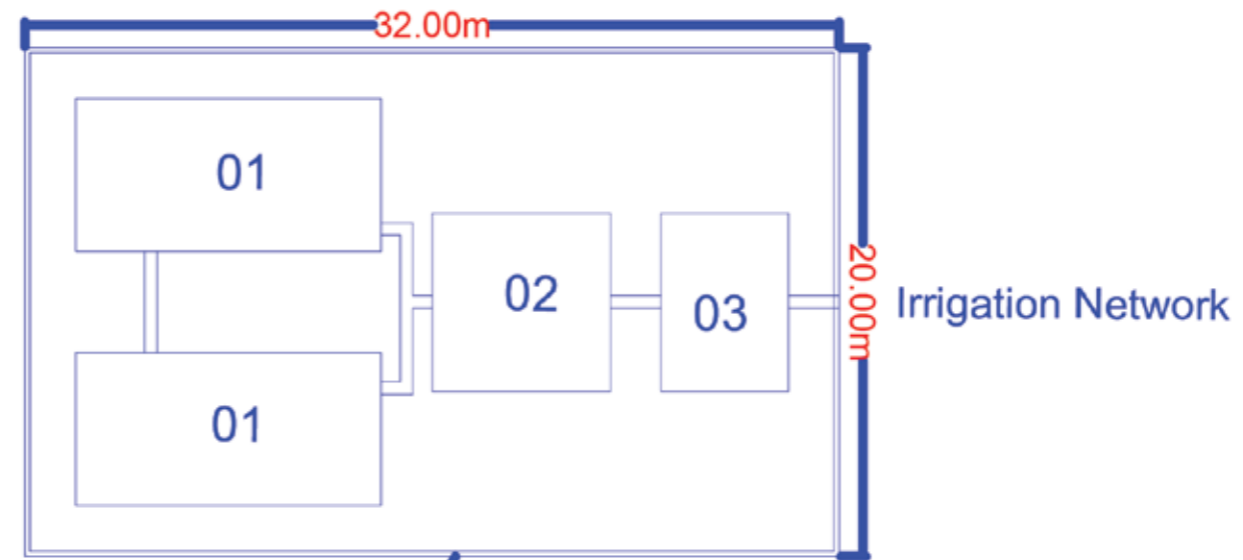

- 01- Septik Tank
- 02- Sewage Treatment Unit
- 03- Irrigation Net Work

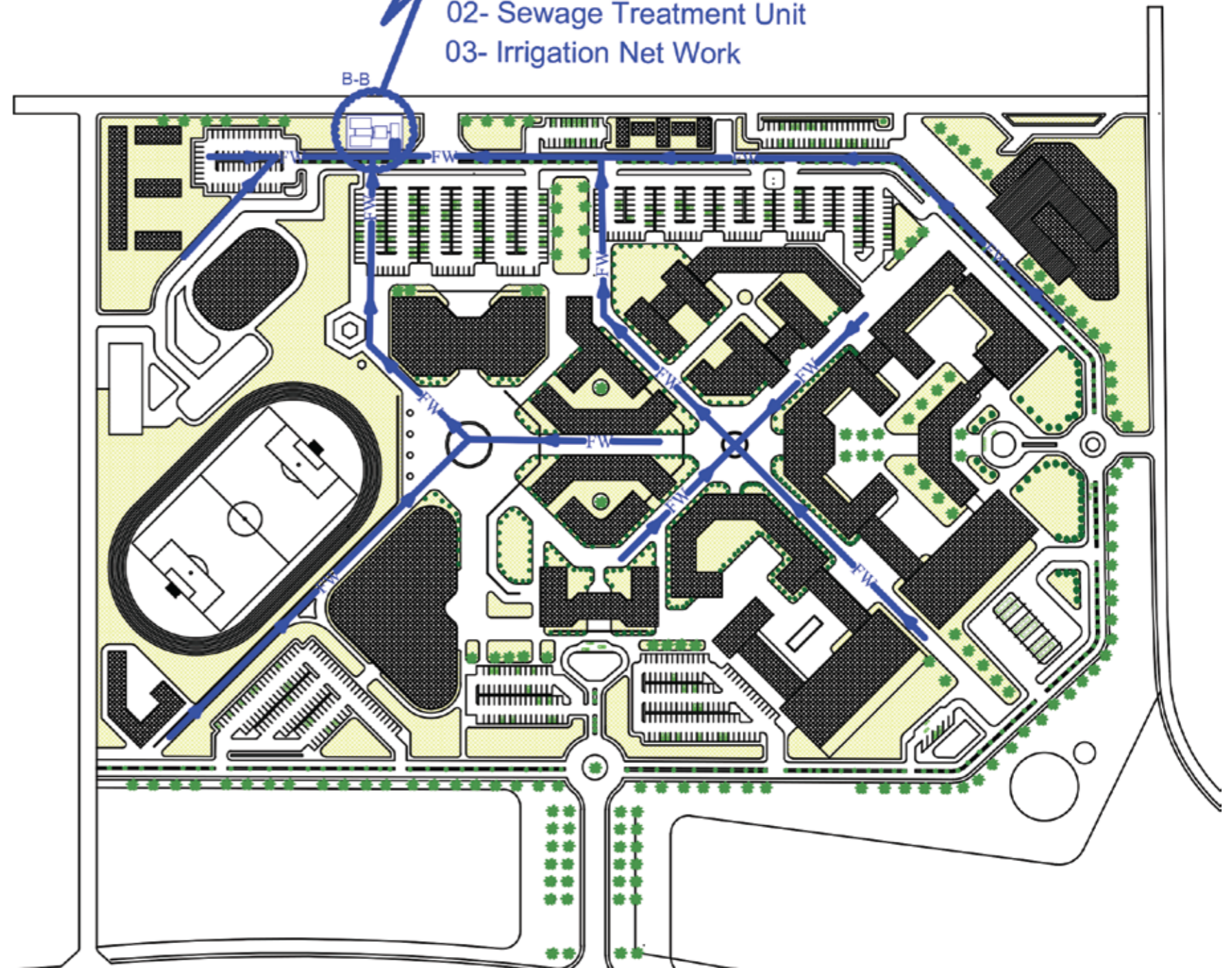



# Vision into Reality

Next steps & Phases of Implementation

## **With the comprehensive LIMU Campus masterplan in place, it is time to shift our focus toward the next steps:**

- Phasing: It is crucial to have a clear implementation timeline for the successful execution of the master plan.
- Prepare a design drawing package for the buildings that are targeted in the upcoming phases. This package will consist of architectural, structural, electrical, and mechanical design drawings, along with the operating plans.
- Other pre-implementation conditions that should be considered such as securing funding and engaging stakeholders.

# Suggested Phases Implementation

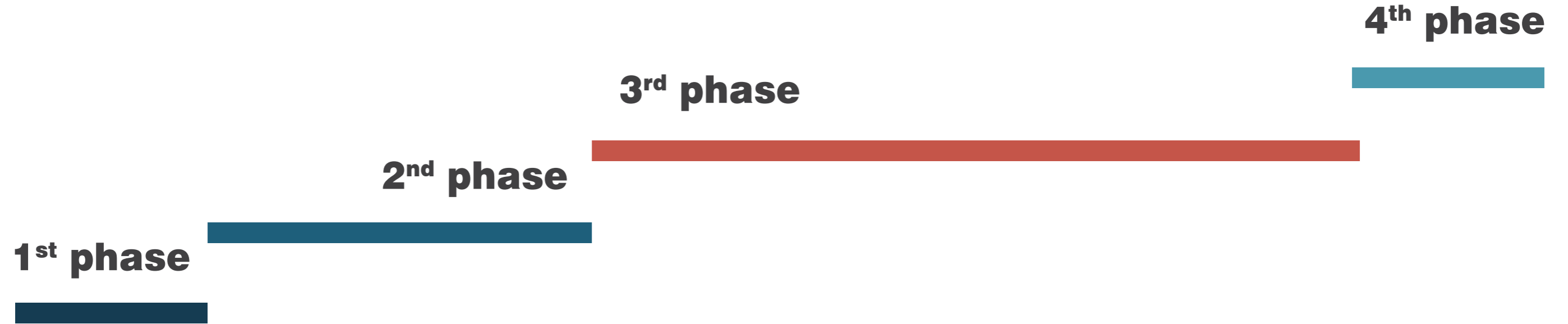

- Includes external fence, entry gates.
- Water management and water tanks.
- Electricity and external lighting network, voltage reduction stations.
- roads, parking lots.
- rainwater mangement , and sewage tanks.
- The implementation of the roads can be postponed for another phase.

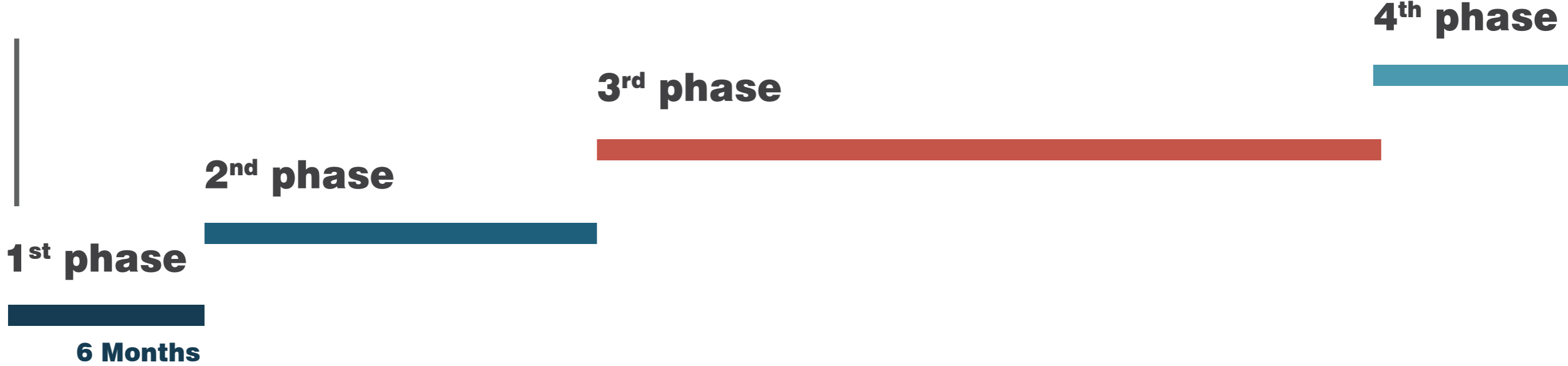

- The Hospital .
- Furnishings and medical devices are not included.

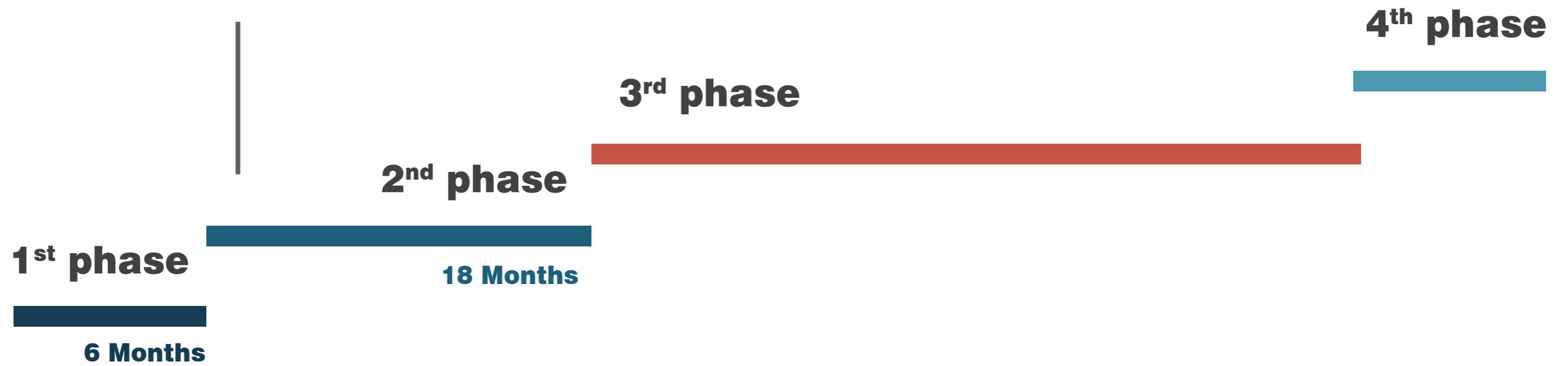

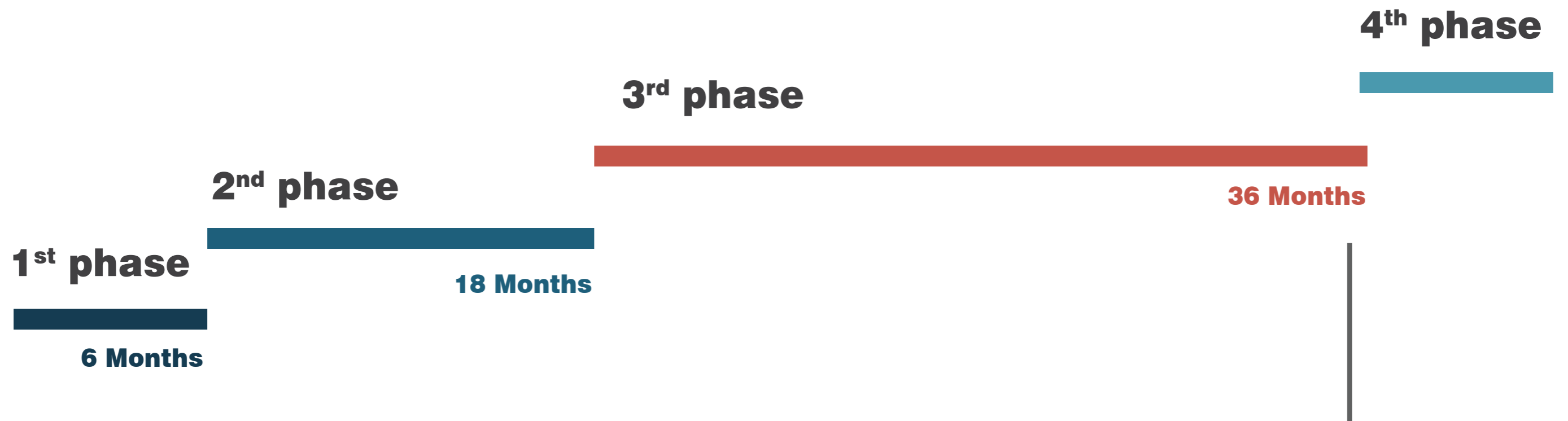

- The squares and the exterior courtyards, green areas.
- accommodation buildings, research center, student center, and cafeteria

- The faculties, the administration buildings, and the library.

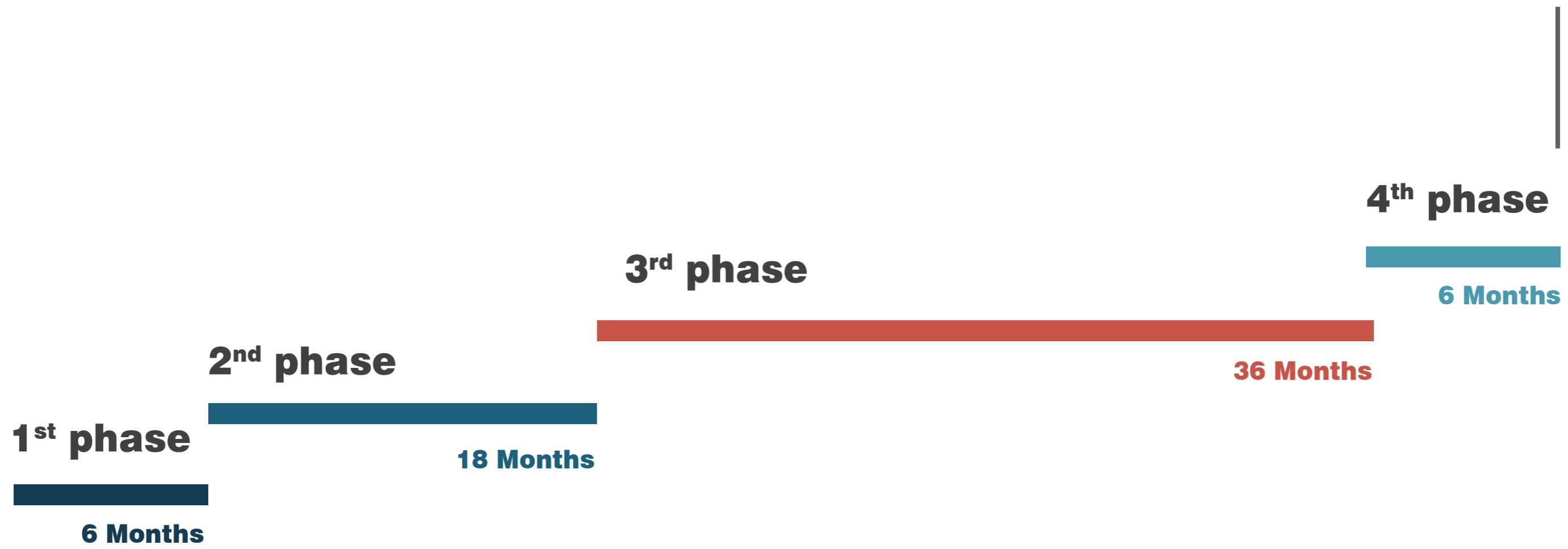

**THANK YOU FOR YOUR ATTENTION.**